



Sharing Research, Best Practices and Lessons Learned in Wetland Management

MAWWG Purpose

The Mid-Atlantic Wetland Workgroup (MAWWG) facilitates a community of practice among scientists and regulators to improve the quality and quantity of wetlands and inform resource management, including sharing strategies to monitor, assess, conserve and restore tidal and non-tidal wetlands in a scientifically sound and implementable manner with a focus on state, tribal and federal programs.

MAWWG forums often spur new projects and partnerships that lead to collaborative efforts to leverage efficiencies and strengthen management of aquatic resources across the region. Information is transferable and facilitates the linkage of regional, state, tribal, and federal programs.

Participants include federal, state and tribal scientists and regulatory personnel, academia, and not-for-profit groups.

Meeting Location and Details

This year's annual Meeting will be held at the Canaan Valley Resort State Park in Davis, West Virginia. Meeting sessions will be held in the Maple Room on the second floor of the main lodge and meals will be served in the Pine room on the first floor.

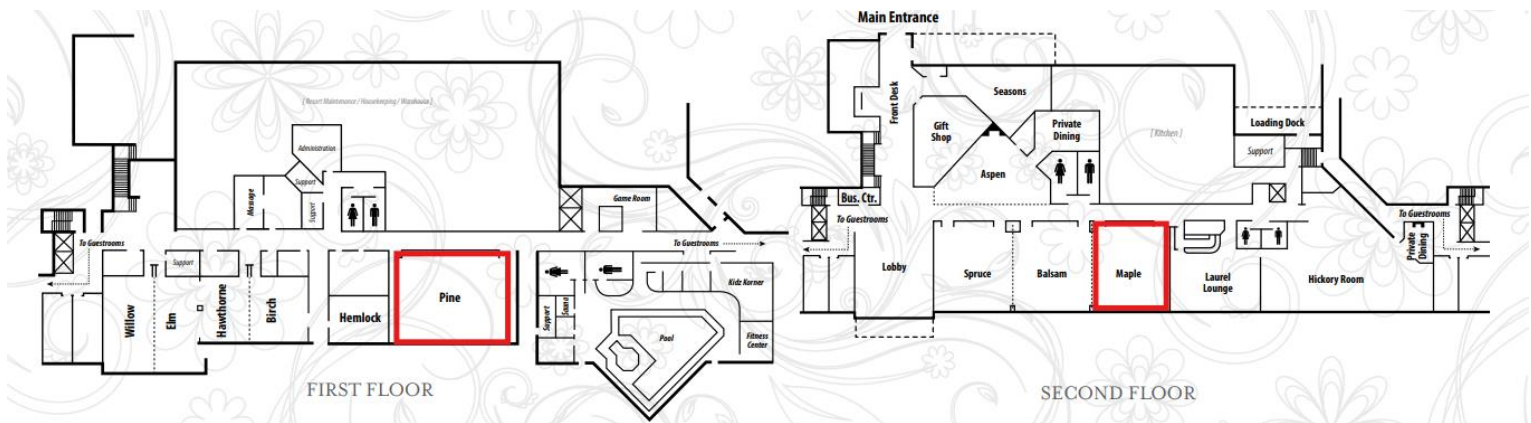

Breakfast will be available each day of the meeting beginning at 7am in the Pine room. After breakfast, please arrive early to the Maple room to sign in and collect your registration materials. A registration table will also be available throughout the meeting for those attending only days 2 or 3.

Lunch and Dinner will also be provided in the Pine room on the first two days of the meeting. Dinner will be served from 6:30-7:30pm.

For those arriving to the meeting early, Canaan Valley Resort state park has a few on-site dining options including the Hickory Dining Room and the Laurel Lounge. More information can be found here: [Dining | Canaan Valley Resort State Park](#)

The state park and surrounding region boast a plethora of natural wonders to explore. Please check out the following map of the park grounds and the points of interest guide prepared by West Virginia DEP to get the most out of your visit to Canaan Valley!

Legend

-  Park boundary
-  Paved road
-  Multiple-use trail (see description)
-  Allegheny Trail
-  Stream/river
-  Lake/pond
-  Parking area
-  Structures
-  Cabin area
-  Campground
-  Downhill skiing
-  Food service
-  Golfing
-  Ice skating
-  Lodging
-  Nature center
-  Park headquarters
-  Scenic viewpoint/overlook
-  Shooting range
-  Ski lift
-  Snowboarding
-  Tubing
-  Swimming
-  Winter recreation

CANAAN MOUNTAIN

CHIMNEY ROCK

BALD KNOB
CABIN MOUNTAIN

WEISS KNOB

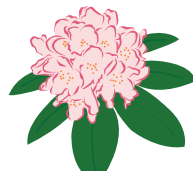
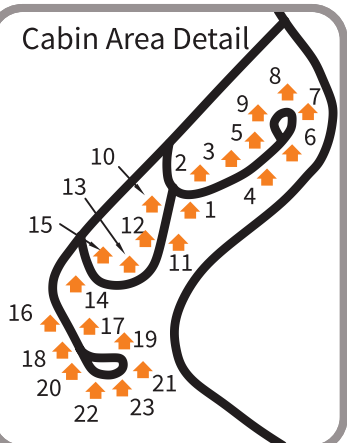
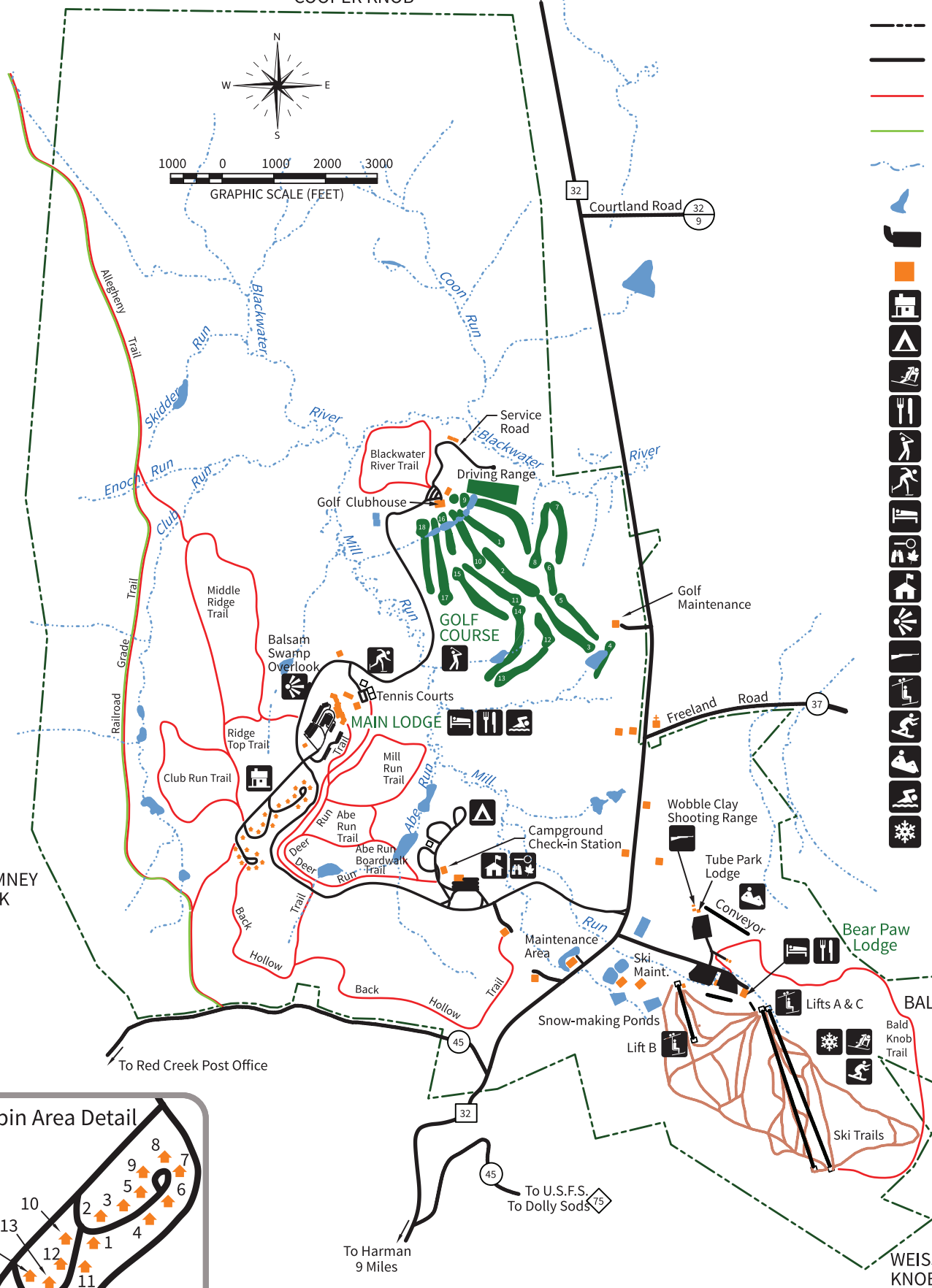
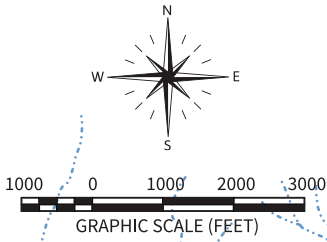

CANAAN VALLEY RESORT STATE PARK

Welcome to Canaan Valley, West Virginia's Wetlands Capitol!

If you get a chance on a travel day or an evening, here are some cool locations to check out!

Please coordinate with WVDEP for cleaning footwear ahead of visiting sites where contact with the wetland may occur. Sites of concern are indicated with an **!** .

Spiraea Swamp off Cortland Road (direct access requires permit)

39.070019, -79.424798

Park at the refuge parking area on Cortland Road- view from the road. Beall Tract trails nearby as well.

The site was logged from 1895-1920 and grazed from 1920-2010, when it was acquired by Canaan Valley National Wildlife Refuge and protected. Cortland Road and Beall Road form the southwest boundary. The North Branch of the Blackwater River forms the eastern boundary. This is a very large *Spiraea alba* swamp with a band of graminoid vegetation along the toeslope on the western boundary.

Glade Run

39.09785, -79.37124

Can be viewed on Middle Valley trail grouping in map (see link).

Wetland is a portion of a larger unit on the Canaan Valley National Wildlife Refuge. Glade Run somewhat forms the eastern barrier of this beaver complex of emergent, *Calmagrostis canadensis* wet meadow and scrub-shrub swamps, one dominated by *Alnus incana* ssp. *rugosa* and one dominated by *Spiraea alba*. At the westernmost end of the northern limb is a small, forested swamp under *Tsuga canadensis*. Permanently ponded beaver ponds are located throughout the wetland along Glade Run and at the downstream end of the northern limb. The northern limb is formed on an unnamed tributary of Glade Run (River Mile 4.22). The southern limb is formed on another unnamed tributary of Glade Run (RM 4.63). Both limbs are predominantly PSS1B.

https://www.fws.gov/sites/default/files/documents/2024-09/cvnwr-trail-map-202409_web.pdf

! Big Run Bog

39.11702, -79.58284

National natural landmark. A full vegetation survey is available here:

<https://boglearningnetwork.com/wp-content/uploads/2014/10/1981-wieder-et-al-vegetational-analysis-of-big-run-bog-a-nonglaciaded-sphagnum-bog-in-west-virginia.pdf>

Freeland Road Boardwalk

39.02525, -79.42633

Short, loop, accessible wetland boardwalk in CVNWR. Access is very close to the main park entrance.

<https://www.fws.gov/refuge/canaan-valley/visit-us/trails>

Inside the Park:

! Balsam Swamp

39.02716, -79.46804

Park here: 39.02553, -79.46696 (or walk down from lodge lot)

Middle Ridge Trail takes you past this wetland

! Abe Run

39.01587, -79.46189

Wetland with boardwalk (Slippery).

Can park at the campground/nature center and walk to the Abe Run trail, or can take the Deer Run trail to the Abe Run trail from the lodge.

<https://www.heartofthehighlandstrail.org/wp-content/uploads/2022/05/CanaanValleyStateParkMap-1.pdf>

Canaan Valley Chairlift

39.00855, -79.43882

Last chair loaded 30 min before sunset. \$15 per person (\$12 if senior).

Can walk Bald Knob Trail back down the mountain if so desired.

<https://www.canaanresort.com/golf-summer-activities/scenic-chairlift-ride/>

Other Attractions:

Blackwater Falls State Park

39.11346, -79.48582

Has titular Blackwater Falls attraction- boardwalk with many stairs down close to the falls, or an accessible overlook on the opposite side of the canyon. Several trails throughout, and a good number of wetland areas. Pendleton Lake has a nature center nearby. There are multiple locations to view the canyon, including the slightly more remote Lindy Point. The trail there can get muddy!

<https://wvstateparks.com/park/blackwater-falls-state-park/>

Douglas Falls

39.12378, -79.51932

On WV's Waterfall Trail.

Can be driven to from Thomas WV

<https://www.wvfalls.com/douglas-falls/>

MAWWG 2025 Agenda Overview

	Day 1 September 23rd	Day 2 September 24th	Day 3 September 25th
8:30 - 8:45	Welcome and Introductions	Recap, Questions, Logistics	Recap, Questions, Logistics
8:45 - 10:15	Session 1: MAWWG History, Purpose, and Goals	State Share-Outs	Session 5: Vernal Pools
10:15 - 10:30	Break	Break	Break
10:30 - 12:00	Session 2: Challenges and Brainstorming	Session 4: Connecting Research to Policy	Session 6: Citizen Science and Outreach
12:00 - 1:00	Lunch	Lunch	
1:00 - 2:30	State Share-Outs	Field Visit	
2:30 - 2:45	Break		
2:45 - 4:15	Session 3: Innovative Tools and Techniques		
4:15 - 4:45	Debrief	Debrief	
	Lingering questions, Discussion of takeaways, Tomorrow's logistics	Lingering questions, Discussion of takeaways, Tomorrow's logistics	

SPEAKERS AND PRESENTATIONS

Tuesday, September 23rd

Day 1 Morning

8:30am – 10:15am **Introductions and Icebreaker**

- **MAWWG History, Purpose, and Goals**
- **Icebreaker Exercise: Goals and Needs**

10:15am – 10:30am **BREAK**

10:30am – 12:00pm **Challenges and Brainstorming**

- **Presentations from EPA and USACE**
- **Group discussion on strategies and needs for filling regulatory gaps**

Day 1 Afternoon

1:00pm – 2:30pm **State/ Tribal Share-Outs**

- **West Virginia**
- **Maryland**
- **Pennsylvania**
- **New Jersey**

2:30pm – 2:45pm **BREAK**

2:45pm – 4:15pm **Innovative Tools and Techniques**

- **Huh?! Revisiting WQC Conditions for the real world:** Jennifer Dietzen, Washington DC DOEE
- **Multi Benefit Accounting of Restoration Projects:** Dave Goerman, Pennsylvania DEP
- **Are New Jersey's Coastal Wetlands Keeping Pace with Sea-level Rise: A Web-Based Tool to Ease Access & Interpretation of Wetland Monitoring Data:** Erin O'Brien, New Jersey DEP
- **Mapping and Tracking Tool for Restoration Projects:** Danielle Spendiff, Maryland Department of the Environment

4:15pm – 4:45pm **Day 1 Debrief**

Wednesday, September 24th

Day 2 Morning

8:30am – 8:45am **Recap and Announcements**

8:45am – 10:15am **State Share-Outs**

- **Chickahominy Tribe**
- **Delaware**
- **Washington DC**
- **Virginia**

10:15am – 10:30am **BREAK**

10:30am – 12:30pm **Connecting Research to Policy**

- **Environmental Assessments and Wetland Impairment Designations for Watersheds with Legacy Sediments:** Dave Goerman, Pennsylvania DEP
- **Developing a Method for the Evaluation of Carbon Flux in New Jersey's Non-tidal Wetlands:** Joshua Moody, New Jersey DEP
- **Road salt effects on nitrogen removal by freshwater urban/suburban wetlands:** Md Moklesur Rahman, University of Delaware
- **Wetland Conservation through WVWRAM Regulatory Use:** Sara Miller, West Virginia DEP

Day 2 Afternoon

12:00pm – 4:15pm **Field Visit**

The group will be visiting several sites in Blackwater Falls State Park including a WVWRAM Assessed wetland and an exemplary peatland. This stop will involve some light hiking and walking- be sure to wear proper footwear for visiting a wetland! Shoes will need to be cleaned prior to the field trip. West Virginia DEP folks will be on hand to do cleanings at breaks throughout the meeting. We will also stop at the Freeland Boardwalk Trail in the Canaan Valley National Wildlife Refuge.

4:15pm – 4:45pm **Day 2 Debrief**

Thursday, September 25th

Day 3 Morning

8:30am – 8:45am **Recap and Announcements**

8:45am – 10:15am **Vernal Pools**

- **Vernal Pool Surface Water Connectivity in the Headwaters of Central Pennsylvania:** Taylor Blackman, Pennsylvania State University
- **Volunteer Vernal Pool Monitoring in West Virginia:** Callie Sams, West Virginia DEP
- **Maine Special Area Management Program:** Aram Calhoun, University of Maine
- **Partnerships to support vernal pool management, restoration and monitoring in Pennsylvania:** Betsy Leppo, Western Pennsylvania Conservancy

10:15am – 10:30am **BREAK**

10:30am – 12:00pm **Citizen Science and Outreach**

- **Why did the Salamander Cross the Road?:** Michelle Campbell, Washington DC DOEE
- **New Roots: Growing Wetland Stewards from Landowners:** Alison Rogerson, Delaware DNREC
- **STEAM into Wetlands: Empowering Educators Through Outdoor Learning:** Tomi Bergstrom, West Virginia DEP
- **Clean Water Academy Training Courses:** Andy McDonald, Pennsylvania DEP